

P.C.B. LAYOUT REF. THICKNESS=1.60mm
TOLERANCE:±0.05mm

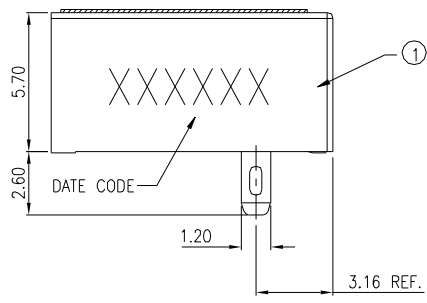

- NOTES:
- MATERIAL:
 - HOUSING: THERMOPLASTIC, HIGH TEMP., UL94V-0; COLOR:BLACK.
 - CONTACT: COPPER ALLOY
 - FITTING NAIL: STAINLESS STEEL ALLOY
 - FINISH:
 - CONTACT:
 - CONTACT:SEE ORDER INFORMATION.
 - 60u" Min MATT TIN PLAING ON SOLDER.
 - 50u" Min NICKEL UNDERPLATED OVERALL.
 - FITTING NAIL:
 - 50u" Min MATT TIN PLAING ON SOLDER.
 - 50u" Min NICKEL UNDERPLATED OVERALL.
 - REFLOW SOLDER CAPABLE TO 260°C PER ACES SPEC.
 - SPEC. PLS. REFER TO PS-50886-xxxx-xxx
 - PACKAGE PLS. REFER TO 51833-xxxx-xx-TRP
 - PART NUMBER

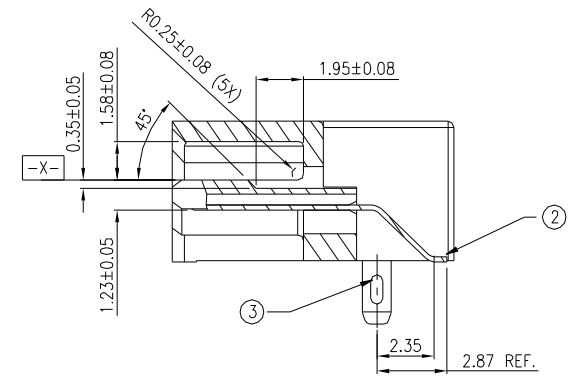
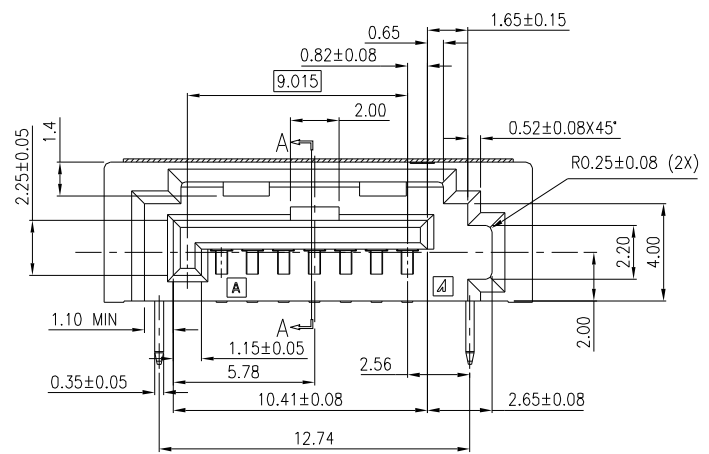
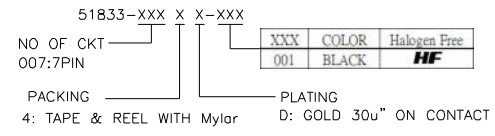

SECTION A-A

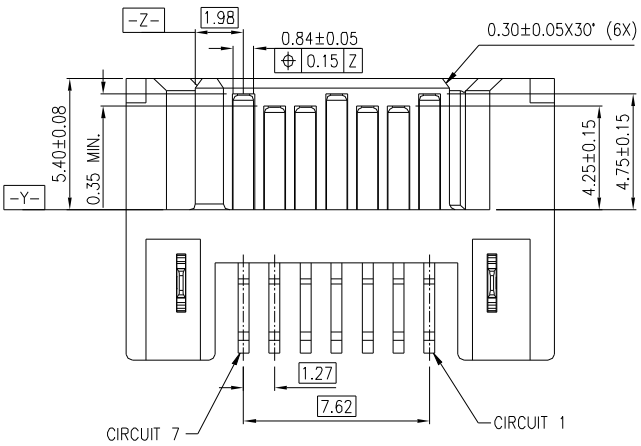

NO.	DESCRIPTION	QTY	MATERIAL	FINISH&COLOR
4	MYLAR	1	POLYIMIDE TAPE	AMBER
3	BOARD LOCK	2	STAINLESS STEEL	MATT TIN
2	CONTACT	7	COPPER ALLOY	GOLD PLATED
1	HOUSING	1	Halogen Free PLASTIC,HIGH TEMP LCP UL94V-0	BLACK

QUALITY SYMBOLS
 MAJOR Ⓢ
 CRITICAL Ⓢ
 GENERAL TOLERANCES (UNLESS SPECIFIED)
 X ±0.5
 XX ±0.30
 XXX ±0.20
 .XXX ±0.05
 ANGLES ±2°

DRAWN BY
Hu, Shul Hong
 CHECKED BY
Lu,ling Quan
 APPROVED BY
hsieh, fu yu
 UNITS
mm
 SCALE
3:1

DATE
20/04/25
 DATE
20/04/25
 DATE
20/04/25
 TITLE
SATA CONN HOST 1.27MM PITCH PLUG./R/A SMT TYPE
 SIZE
A4
 RFG NO.
RFQ-1909091
 REV
B
 DWG NO.
51833-XXXXX-XXX